



Gabriola Island Local Trust Committee

PUBLIC HEARING NOTICE

Proposed Bylaw Nos. 318 and 319
GB-RZ-2022.1 Moen

The Gabriola Island Local Trust Committee invites the public to attend a Public Hearing beginning at **10:35 am, Thursday, November 20, 2025, Gabriola Arts and Heritage Centre, 476 South Road, Gabriola Island**, to hear your views regarding **Proposed Bylaw No. 318 and Proposed Bylaw No. 319**.

What are Bylaw Nos. 318 and 319 about?

Bylaw No. 318 will amend the Gabriola Island Official Community Plan (OCP) to include the subject property in the Village Commercial Land Use Designation and in the Village Centre Development Permit Area (DPA). The DPA establishes objectives for form and character, water conservation and reduction of greenhouse gas emissions. The OCP amendment will also facilitate the ability for the subject property to have two dwelling units and does not require a housing agreement for either these dwellings.

Bylaw No. 319 will amend the Gabriola Island Land Use Bylaw (LUB) to include the subject property in a new site-specific zone, Village Commercial 3. The new zone will allow a broader range of commercial uses including retail sales, garden centre, personal services, restaurant and offices. The floor area for additional commercial additions to the property is limited to 100 square metres unless there is one dwelling, 200 square metres unless there are two dwellings and there is no floor area restriction for commercial uses once there are two dwellings constructed. The zone allows a maximum of two dwelling units which are each limited in floor area to 90 square metres, the dwelling units must be located within the building envelope of a commercial building. The zone also requires a freshwater collection system to be connected to buildings that support a principal use.

These bylaw amendments will apply to 750 Tin Can Alley, Gabriola Island, legally described as: LOT B SECTION 19 GABRIOLA ISLAND NANAIMO DISTRICT PLAN VIP60373 (PID: 023-005-629)

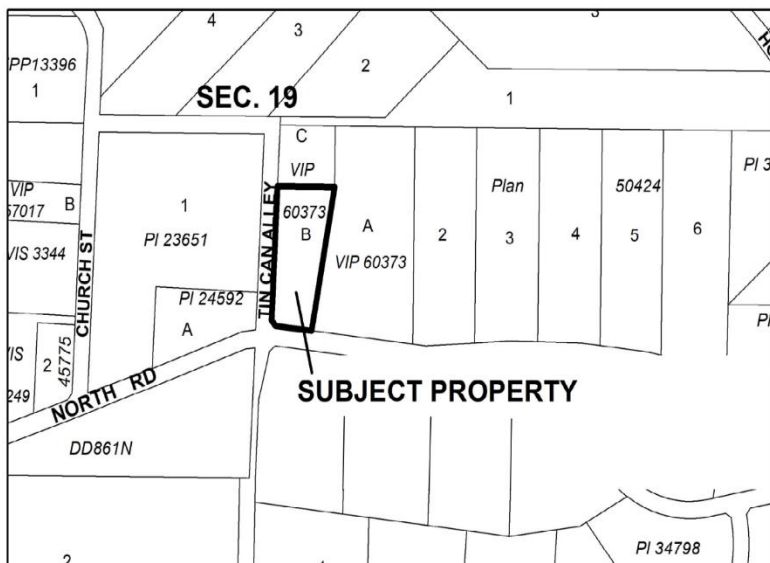

How Do I Get More Information?

Copies of the proposed bylaw, the Public Hearing Binder and other information is available **online** from November 10, 2025 to November 19, 2025 here: <https://islandstrust.bc.ca/island-planning/gabriola/current-applications/> and at the Islands Trust Northern Office, 700 North Road, Gabriola, BC V0R 1X3 from 8:30 a.m. to 4:00 p.m., Tuesday – Thursday excluding statutory holidays.

Enquiries?

Contact the Islands Trust Northern Office, by **email**: northinfo@islandstrust.bc.ca, or **phone**: 250-247-2063.

Written submissions?

Written submissions will be accepted until 4:30 p.m., November 19, 2025 to: Islands Trust, 700 North Road, Gabriola Island, BC, V0R 1X3 or **email**: northphsub@islandstrust.bc.ca

Written submissions made in response to this notice will be available for public review.

NO WRITTEN OR ORAL REPRESENTATIONS WILL BE RECEIVED BY THE GABRIOLA ISLAND LOCAL TRUST COMMITTEE, OR ITS MEMBERS, AFTER THE CONCLUSION OF THE PUBLIC HEARING.

**Nadine Mourao,
Deputy Secretary**

PROPOSED

GABRIOLA ISLAND LOCAL TRUST COMMITTEE BYLAW NO. 318

A BYLAW TO AMEND GABRIOLA ISLAND OFFICIAL COMMUNITY PLAN, 1997

The Gabriola Island Local Trust Committee, being the Trust Committee having jurisdiction in respect of the Gabriola Island Local Trust Area under the *Islands Trust Act*, enacts as follows:

1. Citation

This bylaw may be cited for all purposes as “Gabriola Official Community Plan (Gabriola) Bylaw No. 166, 1997, Amendment No. 1, 2024”.

2. Gabriola Island Local Trust Committee Bylaw No. 166, cited as “Gabriola Island Official Community Plan (Gabriola) Bylaw No. 166, 1997”, is amended as per Schedule “1”, Schedule “2”, and Schedule “3” attached to and forming part of this bylaw

READ A FIRST TIME THIS 4TH DAY OF SEPTEMBER , 2025

READ A SECOND TIME THIS 4TH DAY OF SEPTEMBER , 2025

PUBLIC HEARING HELD THIS _____ DAY OF _____ , 202x

READ A THIRD TIME THIS _____ DAY OF _____ , 202x

APPROVED BY THE EXECUTIVE COMMITTEE OF THE ISLANDS TRUST THIS
_____ DAY OF _____ , 202x

APPROVED BY THE MINISTER OF MUNICIPAL AFFAIRS AND HOUSING THIS
_____ DAY OF _____ , 202x

ADOPTED THIS _____ DAY OF _____ , 202x

Chair

Secretary

GABRIOLA ISLAND LOCAL TRUST COMMITTEE
BYLAW NO. 318
Schedule "1"

1. **Schedule "A"** of Gabriola Island Official Community Plan (Gabriola) Bylaw, 1997 is amended as follows:

- 1.1. **Section 2 – General Land Use and Residential Development**, Subsection **2.0 General Land Use**, Clause 2.0.k) is deleted and replaced with the following text:

“k) This Plan only supports the realization of additional residential density without subdivision when used for Affordable Housing for Special Needs residents, Seniors, multiple-dwelling affordable housing, and two dwellings (with no restrictions on their tenancy or affordability) on the following parcel: LOT B SECTION 19 GABRIOLA ISLAND NANAIMO DISTRICT PLAN VIP60373.”

- 1.2. **Section 3 – Economic Activities**, Subsection **3.1 Commercial Activity, General Commercial Objectives** number 1 is amended by deleting the words “(Lockinvar Triangle area)”.
- 1.3. **Section 3 – Economic Activities**, Subsection **3.1 Commercial Activity, General Commercial Policies** is amended by adding a new clause after clause d) as follows: “e) Despite clause a) and d) a minimum and average parcel size of 1.0 hectare (2.47 acres) and up to 2 dwelling units per parcel may be permitted on the following parcel: LOT B SECTION 19 GABRIOLA ISLAND NANAIMO DISTRICT PLAN VIP60373.”
- 1.4. **Section 3 – Economic Activities**, Subsection **3.2 Village Commercial**, Clause 3.2.a) is amended by deleting the words “(the Lockinvar Triangle area)”.
- 1.5. **Section 3 – Economic Activities**, Subsection **3.4 Local Commercial**, Clause 3.4.a), is amended by deleting Item 3.4.a)ii in its entirety and by making such consequential numbering alterations to effect this change.

**GABRIOLA ISLAND LOCAL TRUST COMMITTEE
 BYLAW NO. 318
 Schedule "2"**

1. **Schedule "B"** of Gabriola Island Official Community Plan (Gabriola) Bylaw, 1997 is amended as follows:

1.1. **Schedule "B" – Land Use Designations – North Sheet**, is amended by changing the land use designation on the lands described as LOT B SECTION 19 GABRIOLA ISLAND NANAIMO DISTRICT PLAN VIP60373 (750 Tin Can Alley, Gabriola Island PID 023-005-629) from "Commercial (Local)" to "Village Commercial" as shown on Plan No. 1 attached to and forming part of this bylaw, and by making such alterations to Schedule "B" as are required to effect this change.

Plan No. 1

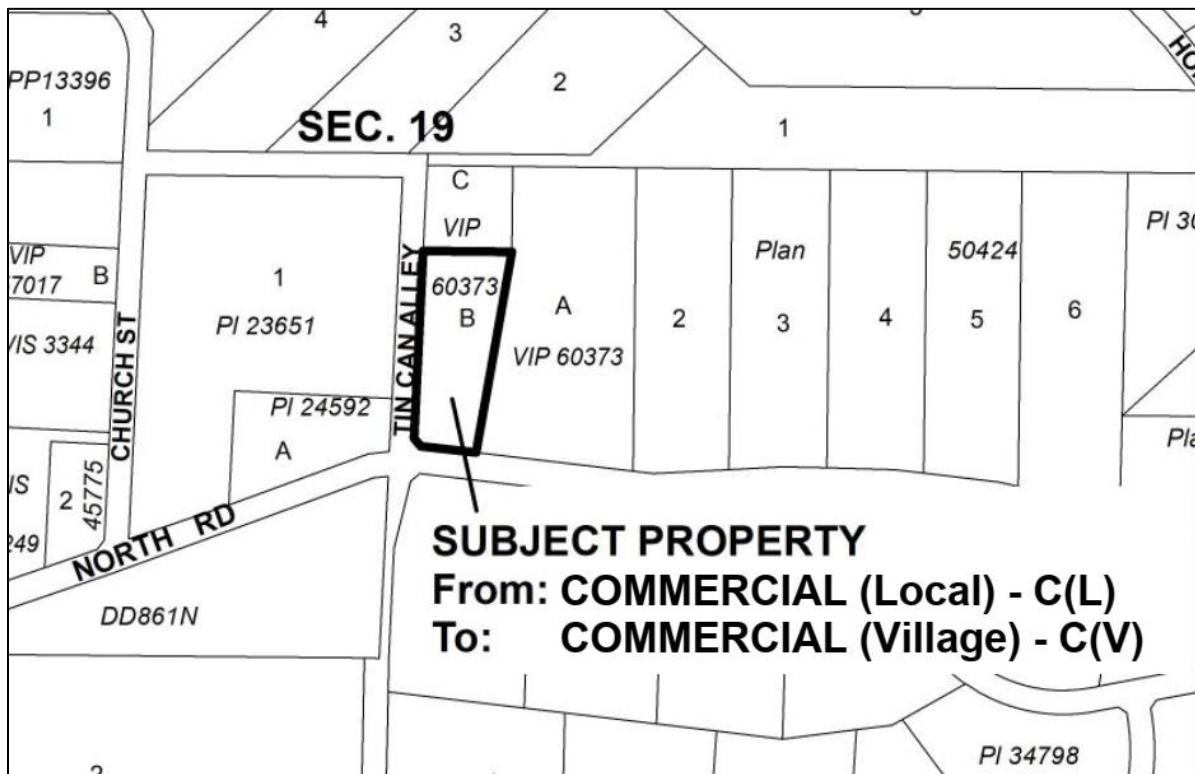

**GABRIOLA ISLAND LOCAL TRUST COMMITTEE
 BYLAW NO. 318
 Schedule "3"**

1. **Schedule "D" – Development Permit Areas - OCP B North Sheet**, is amended by including the lands described as LOT B SECTION 19 GABRIOLA ISLAND NANAIMO DISTRICT PLAN VIP60373 (750 Tin Can Alley, Gabriola Island PID 023-005-629) in the Schedule D map for DP 7 - The Village Centre as shown on Plan No. 2 attached to and forming part of this bylaw, and by making such alterations to Schedule "D" of Bylaw No. 166 as are required to effect this change.

Plan No. 2

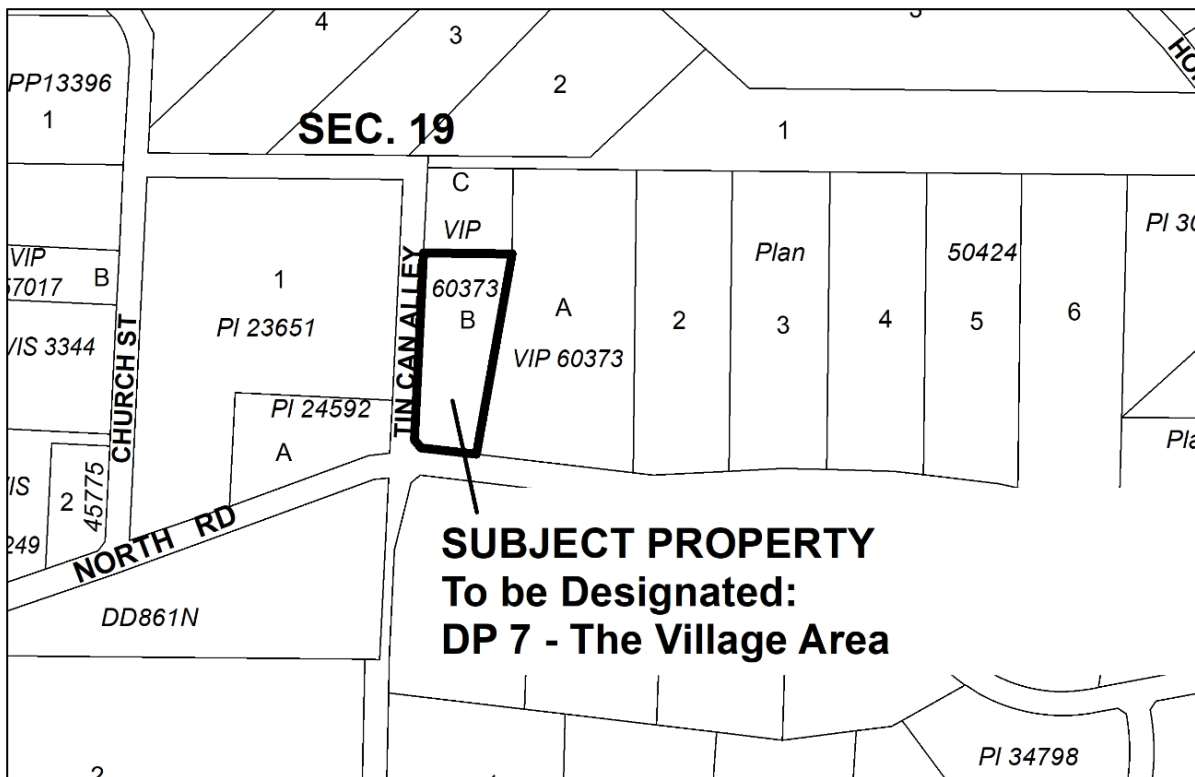

PROPOSED

GABRIOLA ISLAND LOCAL TRUST COMMITTEE BYLAW NO. 319

A BYLAW TO AMEND GABRIOLA ISLAND LAND USE BYLAW, 1999

The Gabriola Island Local Trust Committee, being the Trust Committee having jurisdiction in respect of the Gabriola Island Local Trust Area under the *Islands Trust Act*, enacts as follows:

1. Citation

This bylaw may be cited for all purposes as “Gabriola Island Land Use Bylaw, 1999, Amendment No. 1, 2024”.

2. Gabriola Island Local Trust Committee Bylaw No. 177, cited as “Gabriola Island Land Use Bylaw, 1999” is amended as per Schedule “1” attached to and forming part of this bylaw.

READ A FIRST TIME THIS 4TH DAY OF SEPTEMBER , 2025

READ A SECOND TIME THIS 4TH DAY OF SEPTEMBER , 2025

PUBLIC HEARING HELD THIS _____ DAY OF _____ , 202x

READ A THIRD TIME THIS _____ DAY OF _____ , 202x

APPROVED BY THE EXECUTIVE COMMITTEE OF THE ISLANDS TRUST THIS
_____ DAY OF _____ , 202x

ADOPTED THIS _____ DAY OF _____ , 202x

Chair

Secretary

GABRIOLA ISLAND LOCAL TRUST COMMITTEE
 BYLAW NO. 319

Schedule “1”

1. **Schedule “A”** of Gabriola Island Land Use Bylaw, 1999 is amended as follows:

- 1.1 **Part B GENERAL REGULATIONS**, Section B.1 **USES, BUILDINGS AND STRUCTURES**, Subsection **B.1.1 Permitted in Any Zone**, Article **B.1.1.1 Uses**, Clause B.1.1.1.c. is amended by replacing “D.3.7. Ferry Parking, D.3.10” with “D.3.8. Ferry Parking, D.3.11”.
- 1.2 **Part B GENERAL REGULATIONS**, Section B.4 **SIGNS**, Subsection **B.4.1 Number and Total Sign Area**, Article **B.4.1.1**, Table 1 **Sign Regulations**, Column I is amended by adding “VC3,” after “VC2,”.
- 1.3 **Part B GENERAL REGULATIONS**, Section B.5 **PARKING**, Subsection **B.5.1 Minimum Number of Parking Spaces for Automobiles and Bicycles**, Article **B.5.1.1**, Table 2: **Parking Requirements**, is amended by adding a new row under the “Residential” heading as follows:

<i>dwelling unit</i> in the Village Commercial 3 zone	1 per <i>dwelling unit</i>	None required	None required
--	-------------------------------	------------------	------------------

- 1.4 **Part C ESTABLISHMENT OF ZONES**, Section C.1 **DIVISION INTO ZONES**, Subsection **C.1.1 Land Based Zones**, insert new zone “VC3 Village Commercial 3” after “Village Commercial 2 – Professional Centre” and before “DC1 District Commercial 1”.
- 1.5 **Part D ZONES**, Section D.3 **COMMERCIAL AND INDUSTRIAL ZONES**, insert new Subsection **D.3.3 Village Commercial 3 (VC3)** after Subsection **D.3.2 Village Commercial 2 – Professional Centre(VC2)** as shown in **Appendix 1** attached to and forming part of this bylaw; and renumber all subsequent subsections chronologically.
- 1.6 **Part D ZONES**, Section D.3 **COMMERCIAL AND INDUSTRIAL ZONES**, Subsection **D.3.3 District Commercial 1(DC1)**, Article D.3.3.3 **Regulations**, Clause D.3.3.3.b. **Buildings and Structures Siting Requirements**, Item D.3.3.3.b.iii. is amended by replacing “D.3.3.3.ii” with “D.3.4.3.ii”.
- 1.7 **Part D ZONES**, Section D.3 **COMMERCIAL AND INDUSTRIAL ZONES**, Subsection **D.3.6 Local Commercial 3 – Garden Centres(LC3)**, Article **D.3.6.1 Permitted Uses**, Clause **D.3.6.1.b. Permitted Accessory Uses**, Item **D.3.6.1.b.iii** is amended by deleting the words “except on lands shown on Schedule C, Map 12”.
- 1.8 **Part D ZONES**, Section D.3 **COMMERCIAL AND INDUSTRIAL ZONES**, Subsection **D.3.6 Local Commercial 3 – Garden Centres(LC3)**, Article **D.3.6.1 Permitted Uses**, Clause **D.3.6.1.b. Permitted Accessory Uses**, Item **D.3.6.1.b.iv** is deleted in its entirety.

- 3.3. Schedule “C” – Map 17, is amended by replacing “Items D.3.8.1.a.v and D.3.8.1.a.viii” with “Items D.3.9.1.a.v and D.3.9.1.a.viii”.

**GABRIOLA ISLAND LOCAL TRUST COMMITTEE
BYLAW NO. 319**

Appendix 1

D.3.3 Village Commercial 3 (VC3)

D.3.3.1 Permitted Uses

The uses permitted in Article B.1.1.1, plus the following uses and no others are permitted in the Village Commercial 3 (VC3) zone:

a. Permitted *Principal* Uses

- i *garden centre*
- ii retail sales and rentals
- iii *personal services*
- iv *restaurant*
- v bakeries
- vi offices
- vii *limited public market*, subject to Subsection B.6.2

b. Permitted *Accessory* Uses

- i *single family residential*
- ii *two family dwelling residential*
- iii mini-storage

D.3.3.2 Buildings and Structures

The *buildings* and *structures* permitted in Article B.1.1.2, plus the following *buildings* and *structures* and no others are permitted in the Village Commercial 3 (VC3) zone:

a. Permitted *Buildings* and *Structures*

- i *Buildings* and *structures* to accommodate *principal* uses set out in this zone which must be connected to a freshwater collection system with a minimum storage capacity of 22,500 litres (5,944 US gallons).
- ii Maximum of:
 - two *dwelling units* per lot; and
 - two *buildings* per lot that exclude a *pump/utility house* and woodshed, and that are *accessory* to a *dwelling unit*.
- iii The maximum permitted floor area of a *dwelling unit* is 90 square metres (968 square feet)
- iv Other *buildings* and *structures* to accommodate the permitted accessory uses set out in this zone.

D.3.3.3 Regulations

The general regulations in Part B, plus the following regulations apply in the Village Commercial 3 (VC3) zone:

a. Buildings and Structures Height Limitations

- i The maximum *height* of *buildings* and *structures* is 9.0 metres (29.5 feet).

b. Buildings and Structures Siting Requirements

- i The minimum *setback* for *buildings* or *structures* except for a sign, *fence*, or *pump/utility house* is:
 - 6.0 metres (19.7 feet) from the *front lot line*;
 - 6.0 metres (9.8 feet) from any *interior lot line*, except where the *interior lot line* abuts a commercial or industrial *zone* in which case there is no *setback* requirement from the *interior lot line*; and
 - 3.0 metres (9.8 feet) from another *building* sited on the same *lot*.
- ii There is no *setback* requirement from any *exterior side lot line*, except for mini-storage units in which case the minimum *setback* is 4.5 metres.
- iii *Dwelling units* must be located within the building envelope of a commercial building.

c. Lot Coverage Limitations

- i The maximum combined *lot coverage* by *buildings* and *structures* is 40 percent of the *lot* area.

d. Lot Area Requirements for Subdivision

- i The minimum average *lot* area and the minimum *lot* area is 1.0 hectare (2.47 acres).

e. Mini-Storage Limitations

- i The maximum *floor area* is 9.3 square metres (100 square feet) per mini-storage unit.
- ii Mini-storage units must be separated from a highway or from land with zoning permitting a *principal* residential use by a landscape screen, subject to subsection B.2.7, not less than 2.0 metres (6.6 feet) in *height*.

f. Conditions of Use

- i The floor area of any commercial use on the lot shall not be expanded, and no building or structure greater than 100 square metres shall be constructed, or increased in floor area, unless:
 - one dwelling unit for residential use has been constructed on the lot; or
 - a dwelling unit is constructed as part of the construction or expansion of commercial use on the lot.
- ii The floor area of any commercial use on the lot shall not be expanded, and no building or structure greater than 200 square metres shall be constructed, or increased in floor area, unless:
 - two dwelling units for residential use have been constructed on the lot; or
 - two dwelling units are constructed as part of the construction or expansion of commercial use on the lot.